

REVISIONS	
REV	DESCRIPTION
B1	DWG INITIATED

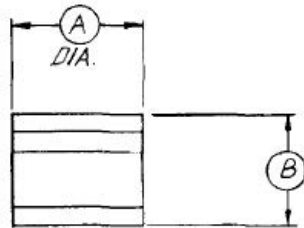

DIM.	INCHES		MM.	
	MAX.	MIN.	MAX.	MIN.
A	.055	.051	1.40	1.29
B	.050	.040	1.27	1.02

NOTE:
1. METAL PARTS TO BE GOLD
PLATED MIN 10M.S.I.

CAUTION
THIS DOCUMENT UNDER
CONFIGURATION CONTROL
REVISIONS TO THIS DOCUMENT
MUST BE REFLECTED ON
CCS. 142400

UNLESS OTHERWISE SPECIFIED INTERPRET DRAWING PER ASME Y14.5 DO NOT SCALE THIS DRAWING	UNLESS OTHERWISE SPECIFIED DIMENSIONS ARE IN INCHES		MACOM Technology Solutions, Inc. 100 Chelmsford Street Lowell, MA 01851																			
	NOTE: THIS DRW INCORPORATES THIRD ANGLE PROJECTION 				TOLERANCES ON <table border="1"> <thead> <tr> <th>DECIMALS</th> <th>ANGLES</th> </tr> </thead> <tbody> <tr> <td>.X ± .1</td> <td rowspan="4">±0.5°</td> </tr> <tr> <td>.XX ± .02</td> </tr> <tr> <td>.XXX ± .005</td> </tr> <tr> <td>.XXXX ± .0005</td> </tr> </tbody> </table>		DECIMALS	ANGLES	.X ± .1	±0.5°	.XX ± .02	.XXX ± .005	.XXXX ± .0005									
DECIMALS	ANGLES																					
.X ± .1	±0.5°																					
.XX ± .02																						
.XXX ± .005																						
.XXXX ± .0005																						
M/A-COM Technology Solutions, INC. CONFIDENTIAL INFORMATION SUBJECT TO NDA <small>The information contained in this document or material is the valuable and confidential property of M/A-COM Technology Solutions Holdings, Inc. and/or its subsidiaries or affiliates (collectively MACOM), provided to you subject to a non-disclosure agreement between you and MACOM solely for use in supporting MACOM's business as and to the extent MACOM authorizes in writing from time to time. This information shall be held in strictest confidence and shall not be reproduced, published, disclosed to others, or used for any purpose except as and to the extent specifically authorized by MACOM in a separate written agreement. If permission is granted for reproduction, this document or material shall be promptly returned to MACOM or destroyed upon request, completion of the use for which it was made available to recipient, or termination of MACOM's relationship with recipient, whichever first occurs.</small>		UNLESS OTHERWISE SPECIFIED $\sqrt[63]{}$ ALL OVER		TITLE <h2 style="text-align: center;">Outline Drawing</h2>																		
<table border="1"> <tr> <td style="text-align: center;">X</td> <td style="text-align: center;">X</td> </tr> <tr> <td style="text-align: center;">NEXT ASSY</td> <td style="text-align: center;">USED ON</td> </tr> <tr> <td colspan="2" style="text-align: center;">APPLICATION</td> </tr> </table>		X	X		NEXT ASSY	USED ON	APPLICATION		MATERIAL X	FINISH X	<table border="1"> <tr> <td>SIZE</td> <td>CAGE CODE</td> <td>DRAWING NO.</td> </tr> <tr> <td style="text-align: center;">A</td> <td style="text-align: center;">55NN2</td> <td style="text-align: center;">OD-S-120</td> </tr> <tr> <td>SCALE:</td> <td>X/X</td> <td>WEIGHT /</td> </tr> <tr> <td colspan="2"></td> <td style="text-align: right;">SHEET 1 OF 1</td> </tr> </table>	SIZE	CAGE CODE	DRAWING NO.	A	55NN2	OD-S-120	SCALE:	X/X	WEIGHT /		
X	X																					
NEXT ASSY	USED ON																					
APPLICATION																						
SIZE	CAGE CODE	DRAWING NO.																				
A	55NN2	OD-S-120																				
SCALE:	X/X	WEIGHT /																				
		SHEET 1 OF 1																				